

THERMOSTAT COMPONENTS

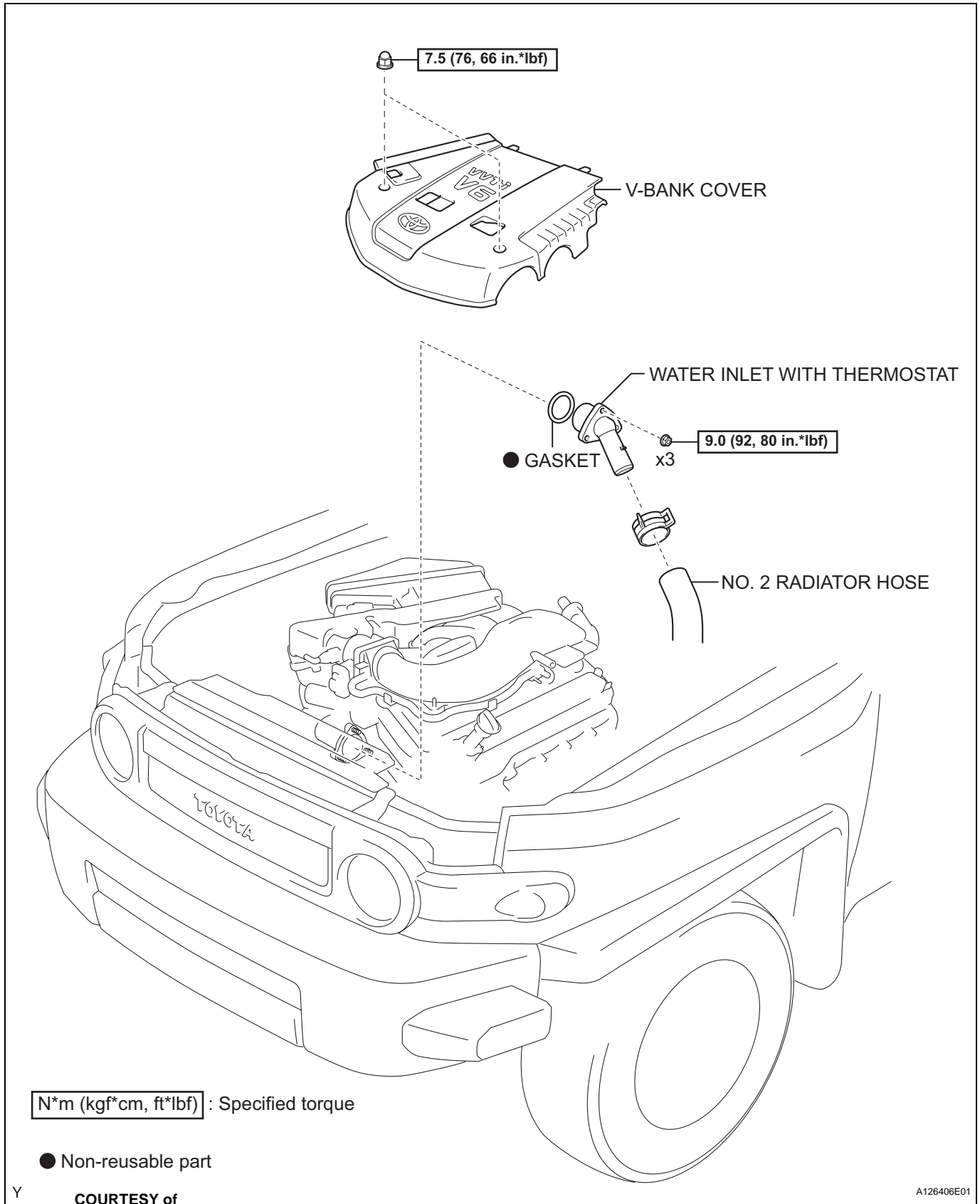

CO

Y



A126406E01

REMOVAL

HINT:

If the thermostat is not installed, cooling efficiency will be reduced. Do not remove the thermostat, to prevent the engine from overheating.

1. **DISCONNECT CABLE FROM NEGATIVE BATTERY TERMINAL**
2. **DRAIN ENGINE COOLANT (See page CO-3)**
3. **REMOVE V-BANK COVER (See page ES-428)**
4. **REMOVE NO. 2 RADIATOR HOSE**
5. **REMOVE WATER INLET WITH THERMOSTAT**
 - (a) Remove the 3 nuts, then remove the water inlet with thermostat and gasket.

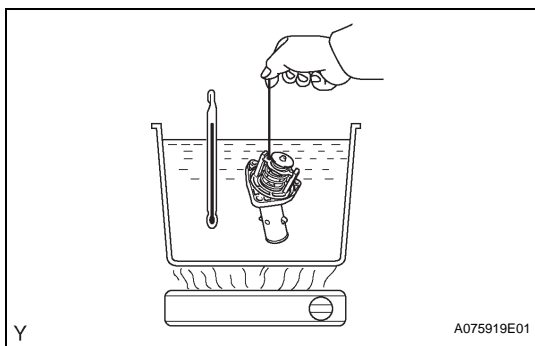
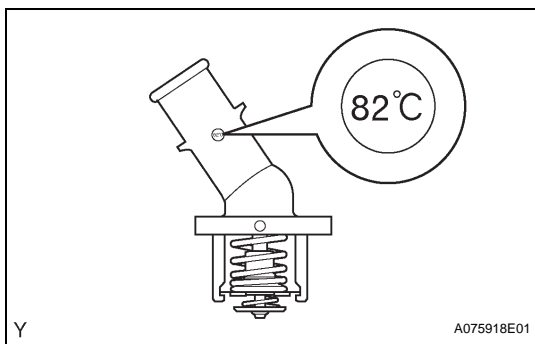
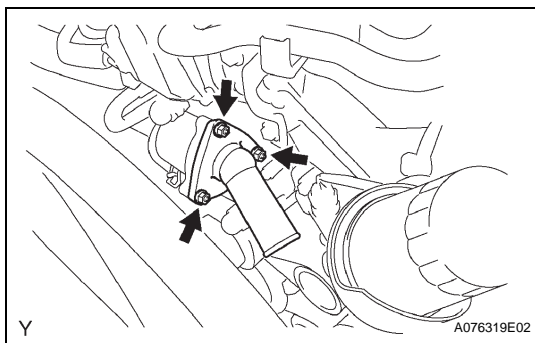

INSPECTION

1. **INSPECT WATER INLET WITH THERMOSTAT**

HINT:

The valve opening temperature is inscribed on the thermostat.

- (a) Immerse the thermostat in water, then gradually heat the water.
- (b) Check the valve opening temperature of the thermostat.

Valve opening temperature:

80 to 84°C (176 to 183°F)

If the valve opening temperature is not as specified, replace the thermostat.

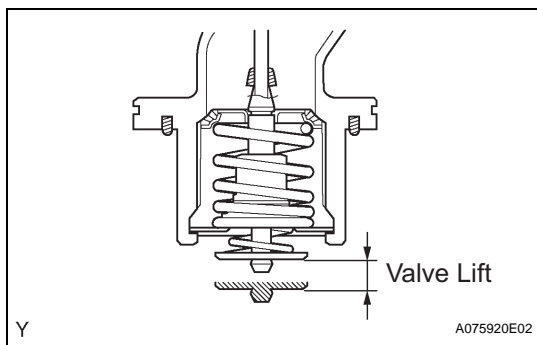

- (c) Check the valve lift.

Valve lift:

8.0 mm (0.31 in.) or more at 95°C (203°F)

If the valve lift is not as specified, replace the thermostat.

- (d) Check that the valve is fully closed when the thermostat is at low temperatures (below 77°C (171°F)).

If not fully closed, replace the thermostat.

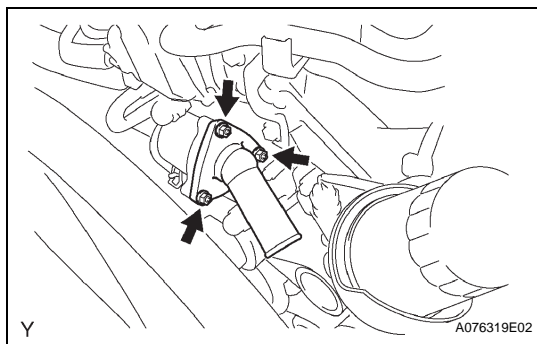

INSTALLATION

1. INSTALL WATER INLET WITH THERMOSTAT

- (a) Install a new gasket onto the water inlet with thermostat.

- (b) Install the water inlet with thermostat with the 3 nuts.

Torque: 9.0 N*m (92 kgf*cm, 80 in.*lbf)

2. CONNECT NO. 2 RADIATOR HOSE

3. CONNECT CABLE TO NEGATIVE BATTERY TERMINAL

Torque: 3.9 N*m (40 kgf*cm, 35 in.*lbf)

4. ADD ENGINE COOLANT (See page [CO-3](#))

5. CHECK FOR ENGINE COOLANT LEAKAGE (See page [CO-4](#))

6. INSTALL V-BANK COVER (See page [ES-431](#))

CO