

# AMPLIFIER BOX SPEAKER ASSEMBLY

## COMPONENTS

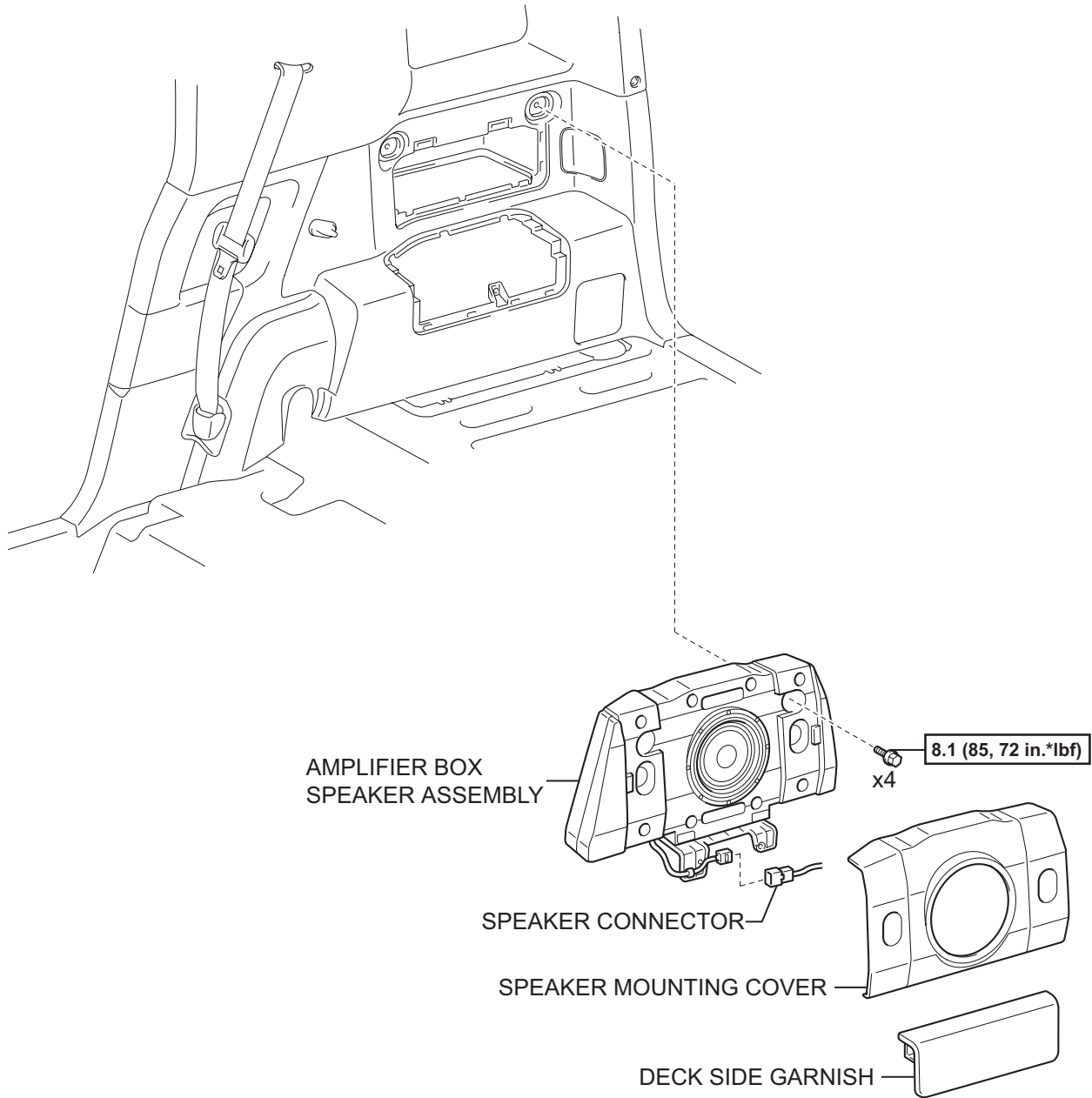

AV

**N\*m (kgf\*cm, ft\*lbf)** : Specified torque

Y

B134988E01

## REMOVAL

1. **DISCONNECT CABLE FROM NEGATIVE BATTERY TERMINAL**
2. **REMOVE DECK SIDE GARNISH (See page IR-18)**
3. **REMOVE SPEAKER MOUNTING COVER**
  - (a) Disengage the 8 clips and remove the speaker mounting cover.

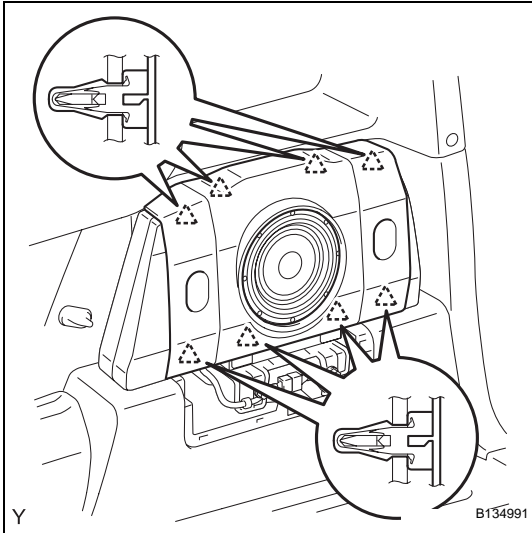

4. **REMOVE AMPLIFIER BOX SPEAKER ASSEMBLY**
  - (a) Disconnect the speaker connector.
  - (b) Remove the 4 screws and the amplifier box speaker.

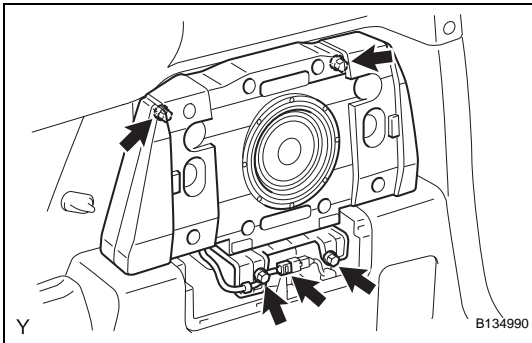

## INSTALLATION

1. **INSTALL AMPLIFIER BOX SPEAKER ASSEMBLY**
  - (a) Install the amplifier box speaker with the 4 screws.  
**Torque: 8.1 N\*m (85 kgf\*cm, 72 in.\*lbf)**
  - (b) Connect the speaker connector.

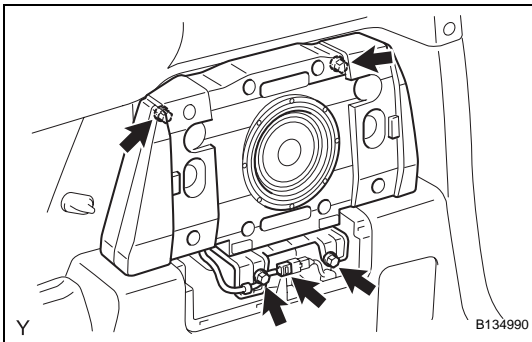

AV

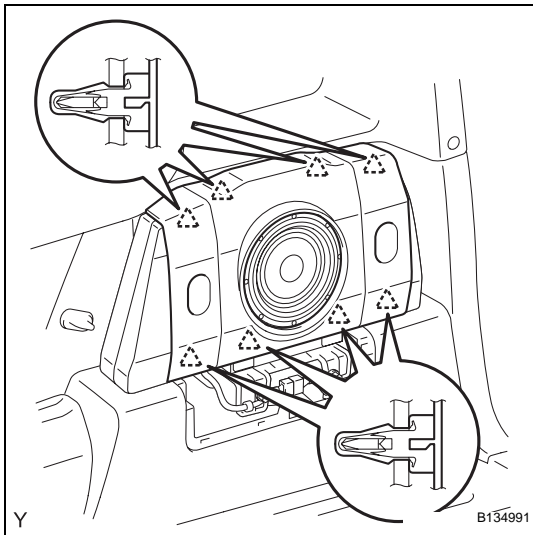

2. **INSTALL SPEAKER MOUNTING COVER**
  - (a) Engage the 8 clips and install the speaker mounting cover.
3. **INSTALL DECK SIDE GARNISH (See page [IR-41](#))**
4. **CONNECT CABLE TO NEGATIVE BATTERY TERMINAL**  
**Torque: 3.9 N\*m (40 kgf\*cm, 35 in.\*lbf)**