

STEERING PAD SWITCH

COMPONENTS

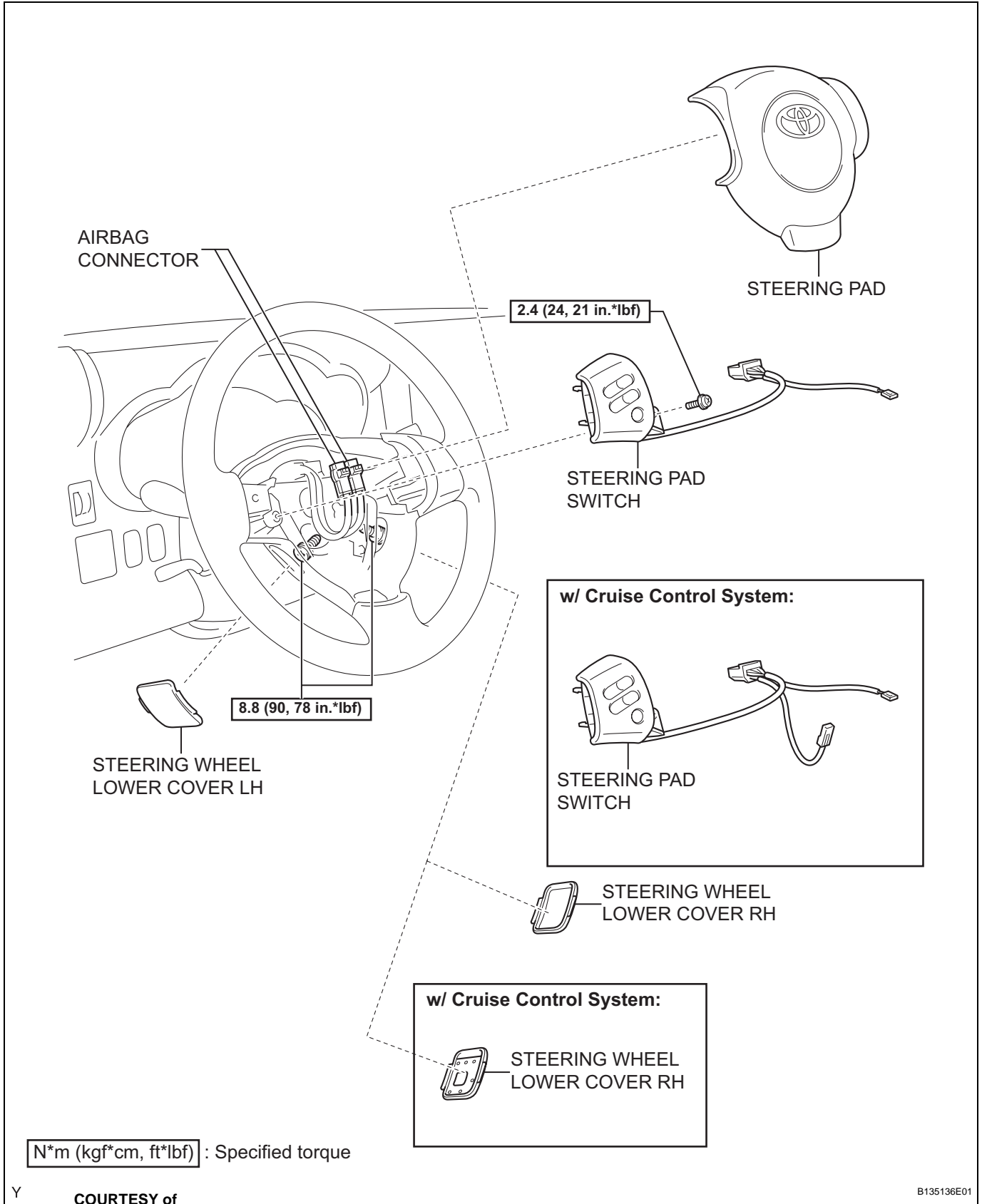

AV

Y

COURTESY of



B135136E01

REMOVAL

CAUTION:

Some of these service operations affect the SRS airbag system. Read the precautionary notices concerning the SRS airbag system before servicing (See page [RS-1](#)).

1. **DISCONNECT CABLE FROM NEGATIVE BATTERY TERMINAL**

CAUTION:

Wait for at least 90 seconds after disconnecting the cable to prevent the airbag from working.

2. **REMOVE STEERING WHEEL LOWER COVER LH**
(See page [RS-345](#))
3. **REMOVE STEERING WHEEL LOWER COVER RH**
(See page [RS-345](#))
4. **REMOVE STEERING PAD** (See page [RS-346](#))
5. **REMOVE STEERING PAD SWITCH**
 - (a) w/ Cruise Control System:
 - (1) Disconnect the cruise control switch connector.
 - (b) Disconnect the connector.
 - (c) Remove the screw.
 - (d) Disengage the 2 claws and the pin and remove the steering pad switch.

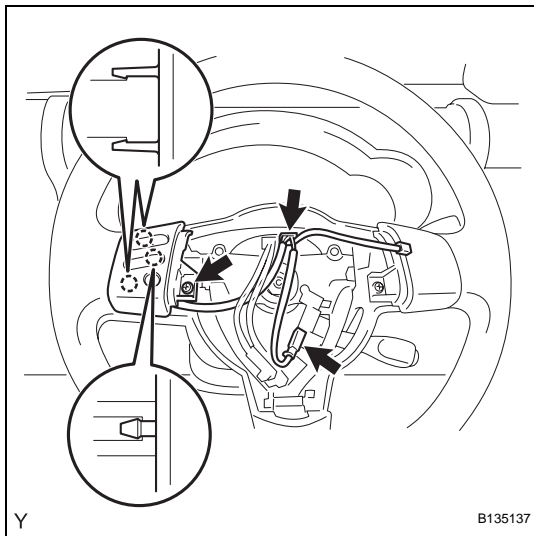

AV