

## ON-VEHICLE INSPECTION

### 1. INSPECT RADIATOR CAP SUB-ASSEMBLY

- (a) Measure the valve opening pressure.
  - (1) If there are water stains or foreign matter on rubber packings 1, 2 or 3, clean the parts with water and finger scouring.
  - (2) Check that rubber packings 1, 2 or 3, is not deformed, cracked or swollen.
  - (3) Check that rubber packings 3 and 4 are not stuck together.
  - (4) Apply engine coolant to rubber packings 2 and 3 before using the radiator cap tester.
  - (5) When using the cap tester, tilt it to more than 30 degrees.
  - (6) Pump the cap tester several times, and check the maximum pressure \*1.

#### Pumping speed:

**1 pump per second.**

\*1: Even if the cap cannot maintain the maximum pressure. it is not a defect.

#### Judgement criteria

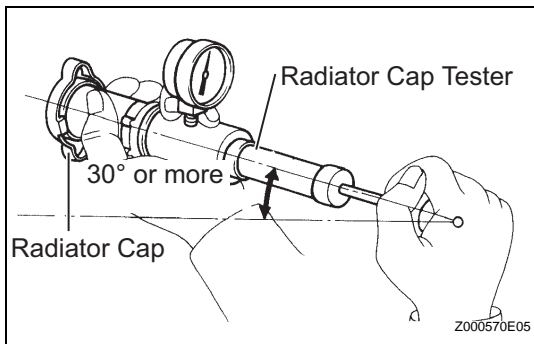

Item	Specified Condition
Standard value (for brand new cap)	93 to 123 kPa (0.95 to 1.25 kgf*cm <sup>2</sup> , 13.5 to 17.8 psi)
Minimum standard value (after using cap)	78 kPa (0.8 kgf*cm <sup>2</sup> 11.4 psi)

If the maximum pressure is less than the specified pressure for the minimum standard value, replace the radiator cap sub-assembly.

## ON-VEHICLE CLEANING

### 1. CHECK FIN FOR BLOCKAGE

- (a) If the fins are clogged, wash them with water or a steam cleaner, then dry them with compressed air.

#### NOTICE:

- If the steam cleaner is too close to the core, there is a possibility of damaging the fins, so keep to the following injection distances.

Injection Pressure kPa (kgf*cm <sup>2</sup> , psi)	Injection Distance mm (in.)
2,942 to 4,903 (30 to 50, 427 to 711)	300 (11.811)
4,903 to 7,845 (50 to 80, 711 to 1,138)	500 (19.685)

- If the fins are bent, straighten them with a screwdriver or pliers.
- Do not expose electronic components to water.

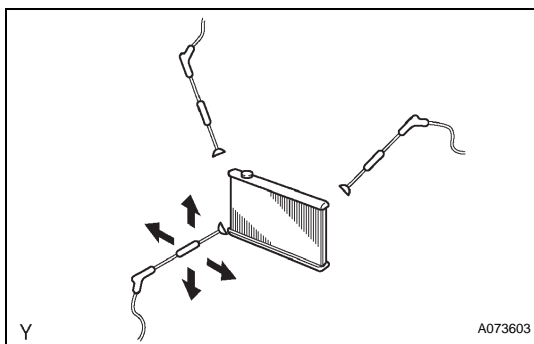

COURTESY of



## REMOVAL

1. DISCONNECT CABLE FROM NEGATIVE BATTERY TERMINAL
2. REMOVE V-BANK COVER (See page [ES-428](#))
3. REMOVE NO. 1 ENGINE UNDER COVER SUB-ASSEMBLY (See page [EM-6](#))
4. DRAIN ENGINE COOLANT (See page [CO-3](#))
5. REMOVE RADIATOR SUPPORT SEAL UPPER
  - (a) Disengage the 7 clips, then remove the radiator support seal.

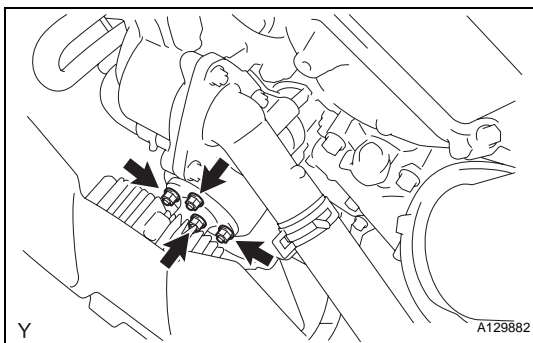
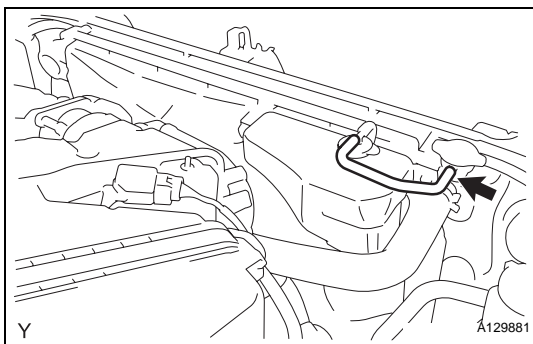
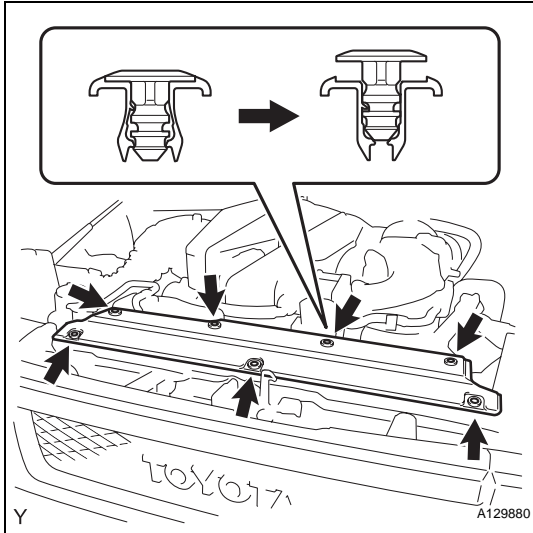

6. REMOVE FAN SHROUD
  - (a) Disconnect the hose from the radiator.
  - (b) Loosen the 4 nuts from the fan pulley.
  - (c) Remove the fan and generator V belt. (See page [EM-6](#))
  - (d) Remove the 4 nuts and the fluid coupling assembly with fan.
  - (e) Remove the bolt from the reserve tank.

CO





