

REMOVAL

CAUTION:

Some of these service operations affect the SRS airbag system. Read the precautionary notices concerning the SRS airbag system before servicing (See page [RS-1](#)).

HINT:

Use the same procedure for both the RH and LH sides.

1. **BOLTS, SCREWS AND NUTS TABLE** (See page [IP-9](#))
2. **DISCONNECT CABLE FROM NEGATIVE BATTERY TERMINAL**
Wait for at least 90 seconds after disconnecting the cable to prevent the airbag from working.
3. **DISCHARGE REFRIGERANT FROM REFRIGERATION SYSTEM** (See page [AC-16](#))
4. **DRAIN ENGINE COOLANT** (See page [CO-3](#))
5. **REMOVE ROOF ANTENNA POLE SUB-ASSEMBLY** (See page [AV-116](#))
6. **REMOVE WINDSHIELD WIPER ARM COVER** (See page [WW-25](#))
7. **REMOVE FRONT WIPER ARM AND BLADE ASSEMBLY LH** (See page [WW-26](#))
8. **REMOVE FRONT WIPER ARM AND BLADE ASSEMBLY RH (CENTER SIDE)** (See page [WW-26](#))
9. **REMOVE FRONT WIPER ARM AND BLADE ASSEMBLY RH** (See page [WW-26](#))
10. **REMOVE FRONT FENDER SIDE PANEL UPPER LH** (See page [WW-26](#))
11. **REMOVE ANTENNA ORNAMENT** (See page [WW-26](#))
12. **REMOVE FRONT FENDER SIDE PANEL UPPER RH** (See page [WW-26](#))
13. **REMOVE COWL TOP VENTILATOR LOUVER ASSEMBLY** (See page [WW-27](#))
14. **REMOVE COWL TOP VENTILATOR LOUVER RH** (See page [WW-27](#))
15. **REMOVE COWL TOP VENTILATOR LOUVER LH** (See page [WW-27](#))
16. **DISCONNECT COOLER REFRIGERANT SUCTION PIPE A** (See page [AC-32](#))
17. **DISCONNECT COOLER REFRIGERANT LIQUID PIPE A** (See page [AC-33](#))
18. **DISCONNECT HEATER INLET WATER HOSE** (See page [AC-33](#))
19. **DISCONNECT HEATER WATER OUTLET HOSE A (FROM HEATER UNIT)** (See page [AC-33](#))

AC

20. POSITION FRONT WHEELS FACING STRAIGHT AHEAD
21. REMOVE LOWER NO. 3 STEERING WHEEL COVER (See page [RS-345](#))
22. REMOVE LOWER NO. 2 STEERING WHEEL COVER (See page [RS-345](#))
23. REMOVE STEERING PAD (See page [RS-346](#))
24. REMOVE STEERING WHEEL ASSEMBLY (See page [SR-8](#))
25. REMOVE LOWER STEERING COLUMN COVER (See page [SR-8](#))
26. REMOVE UPPER STEERING COLUMN COVER (See page [SR-8](#))
27. REMOVE COMBINATION SWITCH ASSEMBLY (See page [SR-9](#))
28. REMOVE FRONT DOOR SCUFF PLATE RH (See page [IR-15](#))
29. REMOVE FRONT DOOR SCUFF PLATE LH (See page [IR-15](#))
30. REMOVE FRONT FLOOR FOOTREST (See page [IR-2](#))
31. REMOVE FOOTREST CLIP (See page [IR-2](#))
32. REMOVE COWL SIDE TRIM BOARD RH (See page [IR-15](#))
33. REMOVE COWL SIDE TRIM BOARD LH (See page [IR-15](#))
34. REMOVE FRONT DOOR OPENING TRIM WEATHERSTRIP RH (See page [IP-10](#))
35. REMOVE FRONT DOOR OPENING TRIM WEATHERSTRIP LH (See page [IP-10](#))
36. REMOVE ASSIST GRIP PLUG (See page [IR-17](#))
37. REMOVE ASSIST GRIP ASSEMBLY (See page [IR-17](#))
38. REMOVE FRONT PILLAR GARNISH RH (See page [IR-18](#))
39. REMOVE FRONT PILLAR GARNISH LH (See page [IR-18](#))
40. REMOVE INSTRUMENT PANEL GARNISH LH (See page [IP-10](#))
41. REMOVE INSTRUMENT PANEL GARNISH RH (See page [IP-10](#))
42. REMOVE INTEGRATION CONTROL AND PANEL ASSEMBLY (See page [IP-11](#))
43. REMOVE RADIO RECEIVER ASSEMBLY (See page [AV-55](#))

44. REMOVE PARKING BRAKE HOLE COVER SUB-ASSEMBLY (See page [IP-11](#))
45. REMOVE SHIFT LEVER KNOB SUB-ASSEMBLY (for Manual Transmission) (See page [IP-11](#))
46. REMOVE SHIFT LEVER KNOB SUB-ASSEMBLY (for 4WD) (See page [IP-11](#))
47. REMOVE CONSOLE UPPER REAR PANEL SUB-ASSEMBLY (See page [IP-12](#))
48. REMOVE BOX BOTTOM MAT (See page [IP-12](#))
49. REMOVE FRONT CONSOLE BOX (See page [IP-12](#))
50. REMOVE CONSOLE UPPER PANEL NO. 1 GARNISH (See page [IP-12](#))
51. REMOVE INSTRUMENT LOWER COVER SUB-ASSEMBLY (See page [IP-13](#))
52. REMOVE NO. 1 INSTRUMENT PANEL REGISTER ASSEMBLY (See page [IP-13](#))
53. SEPARATE HOOD LOCK CONTROL LEVER SUB-ASSEMBLY (See page [IP-13](#))
54. REMOVE LOWER INSTRUMENT PANEL FINISH PANEL SUB-ASSEMBLY LH (See page [IP-14](#))
55. REMOVE LOWER INSTRUMENT PANEL LH (See page [IP-14](#))
56. REMOVE INSTRUMENT CLUSTER FINISH PANEL (See page [IP-14](#))
57. REMOVE COMBINATION METER ASSEMBLY (See page [IP-14](#))
58. REMOVE GLOVE COMPARTMENT DOOR ASSEMBLY (See page [IP-15](#))
59. REMOVE INSTRUMENT PANEL LOWER FINISH PANEL SUB-ASSEMBLY RH (See page [IP-15](#))
60. REMOVE NO. 2 INSTRUMENT PANEL REGISTER ASSEMBLY (See page [IP-16](#))
61. REMOVE NO. 2 INSTRUMENT PANEL SPEAKER PANEL SUB-ASSEMBLY (See page [IP-16](#))
62. REMOVE NO. 1 INSTRUMENT PANEL SPEAKER PANEL SUB-ASSEMBLY (See page [IP-16](#))
63. REMOVE FRONT NO. 2 SPEAKER ASSEMBLY (See page [AV-62](#))
64. REMOVE ASSIST GRIP RETAINER RH (See page [IP-16](#))
65. REMOVE ASSIST GRIP RETAINER LH (See page [IP-16](#))
66. DISCONNECT PASSENGER AIRBAG CONNECTOR (See page [IP-16](#))

AC

AC

67. REMOVE INSTRUMENT PANEL SUB-ASSEMBLY (See page [IP-16](#))
68. REMOVE INSTRUMENT PANEL FINISH PANEL END LH (See page [IP-21](#))
69. REMOVE NO. 1 HEATER TO REGISTER DUCT (See page [AC-35](#))
70. REMOVE NO. 2 HEATER TO REGISTER DUCT (See page [AC-36](#))
71. REMOVE REAR NO. 1 AIR DUCT (See page [AC-36](#))
72. REMOVE REAR NO. 2 AIR DUCT (See page [AC-36](#))
73. REMOVE NO. 1 AIR DUCT (See page [AC-36](#))
74. REMOVE NO. 2 AIR DUCT (See page [AC-36](#))
75. REMOVE NO. 1 INSTRUMENT PANEL BRACE MOUNTING BRACKET (See page [AC-37](#))
76. REMOVE ECM (See page [ES-446](#))
77. REMOVE STEERING COLUMN HOLE COVER (See page [SR-9](#))
78. SEPARATE STEERING INTERMEDIATE SHAFT ASSEMBLY (See page [AC-37](#))
79. REMOVE STEERING COLUMN ASSEMBLY (See page [SR-10](#))
80. REMOVE INSTRUMENT PANEL SIDE BRACKET (See page [AC-37](#))
81. SEPARATE MAIN BODY ECU (DRIVER SIDE J/B) (See page [AC-38](#))
82. REMOVE COOLER UNIT DRAIN HOSE (See page [AC-38](#))
83. REMOVE INSTRUMENT PANEL REINFORCEMENT (See page [AC-38](#))
84. REMOVE BLOWER UNIT ASSEMBLY
 - (a) Remove the 2 screws.
 - (b) Remove the blower unit as shown in the illustration.

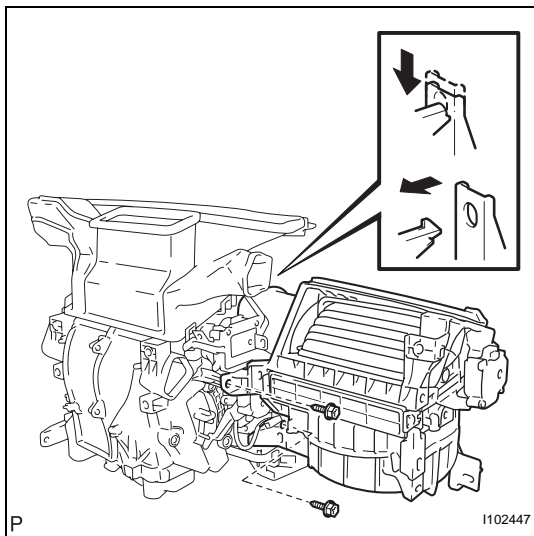

COURTESY of

