

## REMOVAL

### CAUTION:

Some of these service operations affect the SRS airbag system. Read the precautionary notices concerning the SRS airbag system before servicing (See page [RS-1](#)).

1. DISCONNECT CABLE FROM NEGATIVE BATTERY TERMINAL

### CAUTION:

Wait for at least 90 seconds after disconnecting the cable to prevent the airbag from working.

2. REMOVE FRONT DOOR SCUFF PLATE RH (See page [IR-15](#))
3. REMOVE FRONT DOOR SCUFF PLATE LH (See page [IR-15](#))
4. REMOVE FRONT FLOOR FOOTREST (See page [IR-2](#))
5. REMOVE FOOTREST CLIP (See page [IR-2](#))
6. REMOVE COWL SIDE TRIM BOARD RH (See page [IR-15](#))
7. REMOVE COWL SIDE TRIM BOARD LH (See page [IR-15](#))
8. SEPARATE FRONT DOOR OPENING TRIM WEATHERSTRIP RH
  - (a) Remove the front door opening trim weatherstrip to the extent that the front pillar garnish and the instrument panel lower finish panel can be removed.
9. SEPARATE FRONT DOOR OPENING TRIM WEATHERSTRIP LH
 

HINT:  
Use the same procedure as for the RH side.

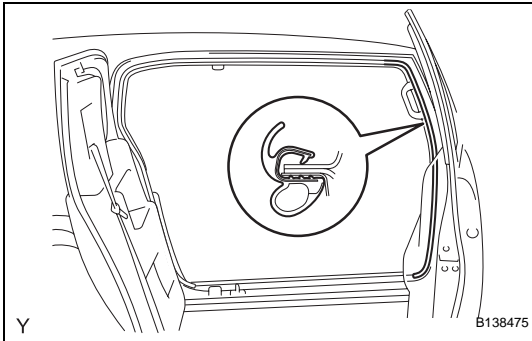

AV

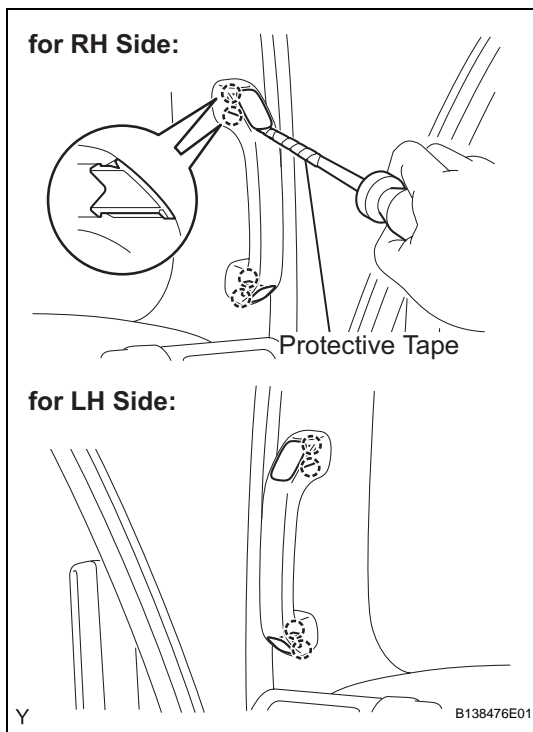
**10. REMOVE ASSIST GRIP PLUG****HINT:**

Use the same procedure to remove all the assist grip plugs.

- (a) Using a screwdriver with its tip wrapped in protective tape, disengage the 2 claws and remove the assist grip plug.

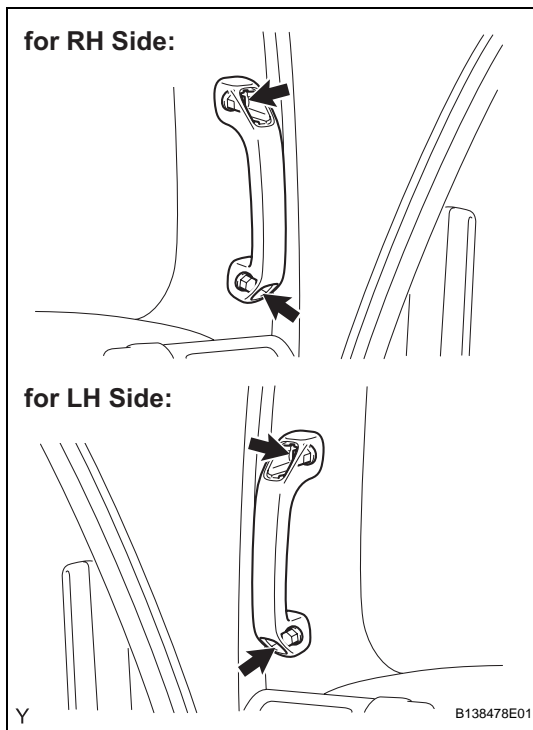
**11. REMOVE ASSIST GRIP ASSEMBLY****HINT:**

Use the same procedure to remove all the assist grips.

- (a) Remove the 2 screws and the assist grip.

**12. REMOVE FRONT PILLAR GARNISH RH (See page IR-18)****13. REMOVE FRONT PILLAR GARNISH LH (See page IR-18)****14. REMOVE ASSIST GRIP RETAINER RH (See page IP-16)****15. REMOVE ASSIST GRIP RETAINER LH (See page IP-16)****16. REMOVE INSTRUMENT PANEL GARNISH LH (See page IP-10)****17. REMOVE INSTRUMENT PANEL GARNISH RH (See page IP-10)****18. REMOVE INTEGRATION CONTROL PANEL ASSEMBLY (See page IP-11)****19. REMOVE RADIO RECEIVER ASSEMBLY (See page AV-55)****20. REMOVE PARKING BRAKE HOLE COVER SUB-ASSEMBLY (See page IP-11)****21. REMOVE SHIFT LEVER KNOB SUB-ASSEMBLY (for Manual Transmission) (See page IP-11)****22. REMOVE SHIFT LEVER KNOB SUB-ASSEMBLY (for 4WD) (See page IP-11)**

COURTESY of



23. REMOVE FRONT CONSOLE BOX UPPER PANEL SUB-ASSEMBLY (See page [IP-12](#))
24. REMOVE FRONT CONSOLE BOX BOTTOM MAT (See page [IP-12](#))
25. REMOVE FRONT CONSOLE BOX (See page [IP-12](#))
26. REMOVE FRONT CONSOLE BOX UPPER PANEL GARNISH (See page [IP-12](#))
27. REMOVE INSTRUMENT LOWER COVER SUB-ASSEMBLY (See page [IP-13](#))
28. REMOVE INSTRUMENT PANEL REGISTER ASSEMBLY LH (See page [IP-13](#))
29. REMOVE HOOD LOCK CONTROL LEVER SUB-ASSEMBLY (See page [IP-13](#))
30. REMOVE INSTRUMENT PANEL LOWER FINISH PANEL SUB-ASSEMBLY LH (See page [IP-14](#))
31. REMOVE INSTRUMENT LOWER PANEL (See page [IP-14](#))
32. REMOVE INSTRUMENT CLUSTER LOWER FINISH PANEL (See page [IP-14](#))
33. REMOVE COMBINATION METER ASSEMBLY (See page [IP-14](#))
34. REMOVE GLOVE COMPARTMENT DOOR ASSEMBLY (See page [IP-15](#))
35. REMOVE INSTRUMENT PANEL LOWER FINISH PANEL SUB-ASSEMBLY RH (See page [IP-15](#))
36. REMOVE INSTRUMENT PANEL REGISTER ASSEMBLY RH (See page [IP-16](#))
37. REMOVE INSTRUMENT PANEL SPEAKER PANEL SUB-ASSEMBLY RH (See page [IP-16](#))
38. REMOVE INSTRUMENT PANEL SPEAKER PANEL SUB-ASSEMBLY LH (See page [IP-16](#))

AV

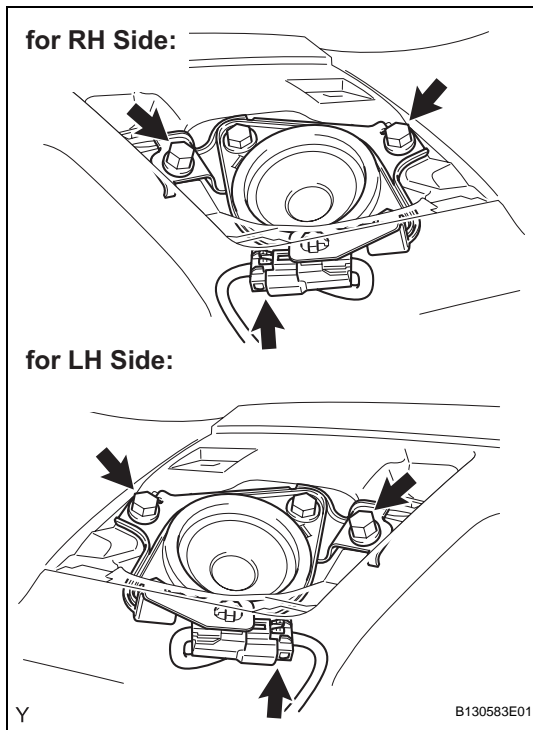
**39. REMOVE FRONT NO. 2 SPEAKER ASSEMBLY****HINT:**

Use the same procedure for both sides.

- (a) Remove the 2 bolts and the front No. 2 speaker.
- (b) Disconnect the speaker connector.

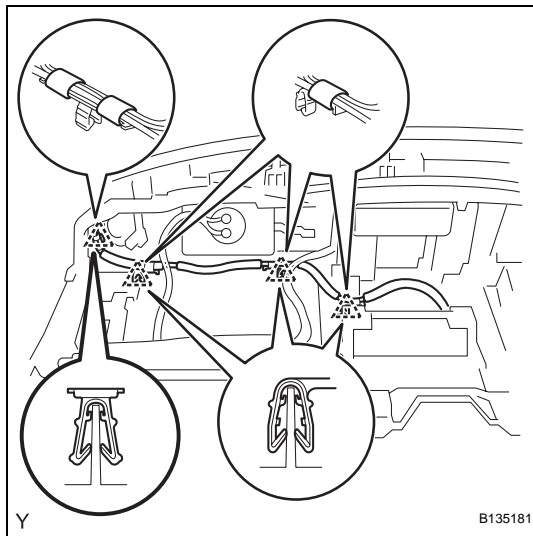
**40. DISCONNECT PASSENGER AIRBAG CONNECTOR  
(See page IP-16)****41. REMOVE INSTRUMENT PANEL SUB-ASSEMBLY  
(See page IP-16)****42. REMOVE INSTRUMENT PANEL FINISH PANEL END  
(See page IP-21)****43. REMOVE ANTENNA CORD SUB-ASSEMBLY**

- (a) Disengage the 4 clamps.
- (b) Remove the 3 pieces of tape and the antenna cord.